

POST-CONSTRUCTION CLEANUP Pricing Guide

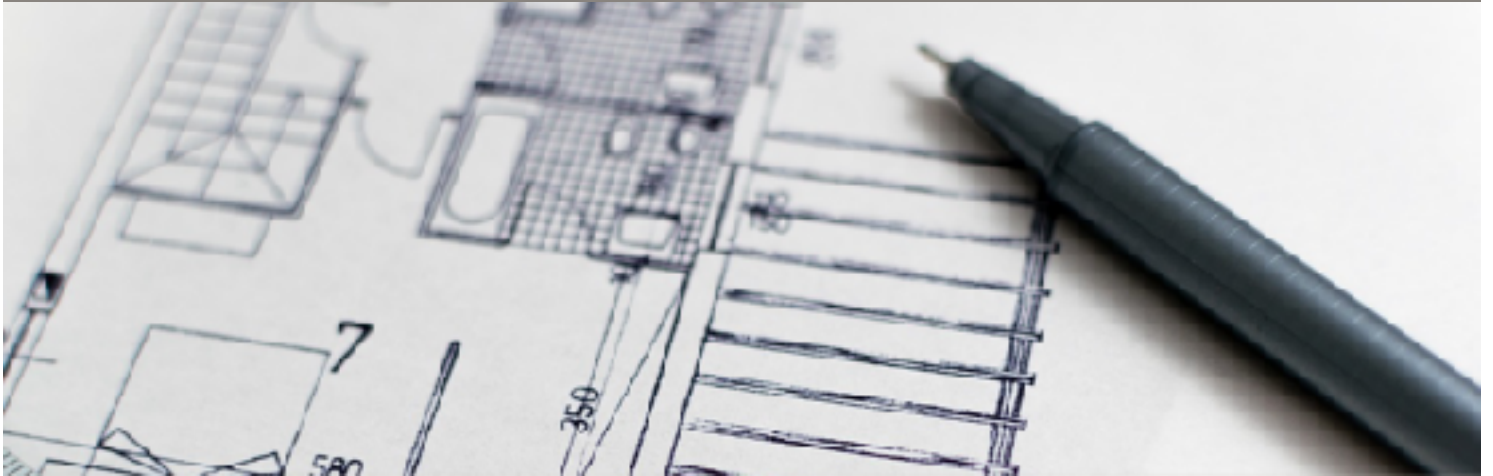

Prices listed are calculated on the average of all projects awarded across North America. Pricing may vary based on scope, mobilization requirements, project type, and location.

Keep in mind that the accepted proposal price may differ from the final contract value.

Project Type	Per sq. ft.	Project Type	Per sq. ft.
<u>Auto Office Bay</u>	\$0.17	<u>Medical or Dental</u>	\$0.32
<u>Bank</u>	\$0.54	<u>Military Installation</u>	\$0.25
<u>Car Dealership</u>	\$0.21	<u>Police or Fire Station</u>	\$0.21
<u>Education</u>	\$0.14	<u>Residential Units</u>	\$0.39
<u>Fitness</u>	\$0.19	<u>Restaurant</u>	\$0.61
<u>Gas Station</u>	\$0.68	<u>Retail</u>	\$0.31
<u>Grocery</u>	\$0.32	<u>Tenant Fit-Out</u>	\$0.41
<u>Industrial</u>	\$0.31	<u>Theater</u>	\$0.21
<u>Library</u>	\$0.49	<u>Worship</u>	\$0.29
Mobilization		Strip and Wax	
Rough Clean	\$0.14	1 coat	\$0.06
Final Clean	\$0.19	2 coats	\$0.13
Fluff	\$0.06	3 coats	\$0.20



CONTACT US
constructioncleanpartners.com
 (307) 298-9335
info@constructioncleanpartners.com